

ORIGINAL INSTRUCTION



**INSTRUCTIONS MANUAL**

**Gas heater 15KW**

**Model: FCD15KW-1**



---

**BUILDER SAS**

**ZI – 32, rue Aristide Bergès, 31270 Cugnaux, France**



**IMPORTANT:** PLEASE READ THESE INSTRUCTIONS CAREFULLY TO ENSURE THE ASFE AND EFFECTIVE USE OF THIS PRODUCT

# CONTENTS

---

Contents/Specification.....	1
General safety instructions.....	2
Additional safety instructions.....	3
Getting to know your gas heaters .....	4
Fuel gases/Ventilation.....	5
Operation and use.....	6-7
Maintenance and storage.....	7
Troubleshooting/Disposal.....	8

# SPECIFICATION

---

Manufacturer policy of continuous improvement determines the right to change specification without notice.

Stock No	FCD15KW-1
Rated voltage	220-240V~ / 50Hz
Motor rated input	28W
Protection class	IP20
Heating output	15KW / 51,100 btu
Air flow	300m <sup>3</sup> /h
Gas consumption	1.07 kg/ hr
Gas Category	LPG / Propane
Net weight	4.7kgs
Regulator pressure output	300 mbar
Min. Gas cylinder size	15kg

# GENERAL SAFETY INSTRUCTIONS

## General Heater safety Warnings

 **Warning:** Read all safety warnings and all instructions. Failure to follow the warnings and instructions may result in electric shock, fire and/or serious injury

Save all warnings and instructions for future reference

### 1) Work area safety

a) Keep work area clean and well lit. Cluttered or dark areas invite accidents.

b) Do not operate heaters in explosive atmospheres, such as in the presence of flammable liquids, gases or dust. Heaters create sparks which may ignite the dust or fumes.

c) Keep children and bystanders away while operating a heater. Distractions can cause you to lose control

### 2) Electrical safety

a) Heaters plugs must match the outlet. Never modify the plug in any way. Do not use any adapter plugs with earthed (grounded) heaters. Unmodified plugs and matching outlets will reduce risk of electric shock.

b) Avoid body contact with earthed or grounded surfaces such as pipes, radiators, ranges and refrigerators. There is an increased risk of electric shock if your body is earthed or grounded

c) Do not expose heaters to rain or wet conditions. Water entering a heater will increase the risk of electric shock.

d) Do not abuse the cord. Never use the cord for carrying, pulling or unplugging the heater. Keep cord away from heat, oil, sharp edges or moving parts. Damaged or entangled cords increase the risk of electric shock.

e) When operating a heater outdoors, use an extension cord suitable for outdoor use. Use of a cord suitable for outdoor use reduces the risk of electric shock.

f) If operating a heater in a damp location is unavoidable, use a residual current device (RCD) protected supply. Use of an RCD reduces the risk of electric shock.

### 3) Personal safety

a) Stay alert, watch what you are doing and use common sense when operating a heater. Do not use a heater while you are tired or under the influence of drugs, alcohol or medication. A moment of inattention while operating heaters may result in serious personal injury

b) Use personal protective equipment. Always wear eye protection. Protective equipment such as dust mask, non-skid safety shoes, hard hat, or hearing protection used for appropriate conditions will reduce personal injuries

c) Prevent unintentional starting. Ensure the switch is in the off position before connecting to power source

d) Remove any adjusting key or wrench before turning the heater on. A wrench or a key left attached to a rotating part of the heater may result in personal injury

e) Dress properly. Do not wear loose clothing or jewellery. Keep your hair, clothing and gloves away from moving parts. Loose clothes, jewellery or long hair can get sucked into the in moving parts of the heater

## 4. Heater use and care

Do NOT move the heater when it is in operation or when plugged into the mains supply. Only move heater once it has cooled and it has been unplugged

a) Use the correct heater for your application. The correct heater will do the job better and safer at the rate for which it was designed

b) Do Not use the heater if the switch does not turn it on and off. Any heater that cannot be controlled with the switch is dangerous and must be repaired

c) Disconnect the plug from the power source before making any adjustments. Such preventive safety measures reduce the risk of starting the heater accidentally

d) Store idle heater out of the reach of children and do not allow persons unfamiliar with the heater or these instructions to operate the power tool. Heaters are dangerous in the hands of untrained users

e) Maintain heaters. Check for misalignment or binding of moving parts, breakage of parts and any other condition that may affect the heater operation. If damaged have the heater repaired before use, Many accidents are caused by poorly maintained heaters.

f) Use the heater in accordance with these instructions, taking into account the working conditions and the work to be performed.

## 5) Service

a) Have your heater serviced by a qualified repair person using only identical replacement parts. This will ensure that the safety of the heater is maintained

## 6) Use in environments with no permanent presence of people

- Warning posters must be displayed prohibiting people from being permanently in that room.

- The gas heater must only be used for room heating purposes only, provided that there is a guaranteed quantity of air exchange necessary for combustion

- The necessary quantity of air will be reached when the volume of the room ( in  $m^3$  ) is at least 10 times the nominal calorific power (in KW) of all gas heaters used in that room.

- Normal air circulation through doors and windows must be ensured

# ADDITIONAL SAFETY INSTRUCTIONS

## 7) Use in environments with permanent presence of people

- The gas heaters can only be used in well-ventilated rooms and when the percentage of pollution substances in the air does not exceed danger levels for health

- A good ventilation is guaranteed when the rooms volume (in m<sup>3</sup>) is at least 30 times the normal calorific power (in KW) of all machines used in that room and when an air circulation, windows or permanent openings can be guaranteed, the size of which (in m<sup>2</sup>) is at least 0.003 times the normal calorific power (In KW) of all machines used in that room. Openings must be also distributed in height

- The concentration of dangerous substances in the air is acceptable until it reaches maximum levels and the percentage of oxygen in the air exceeds 17% in volume

- The apparatus should not be used for continuous heats of stables and farms.

### - WARNING:

Failure to comply with the precautions and instructions provided with this heater, can result in death, serious bodily injury and property loss or damage from hazards of fire, explosion, burn, asphyxiation, carbon monoxide poisoning, and/or electrical shock.

- Only persons who can understand and follow the instructions should use or service this heater

- If you need assistance or heater information such as instructions manual, labels etc. Please contact the vendor

- Checking the heater thoroughly for damage. DO NOT operate a damaged heater

- DO NOT modify the heater or operate a heater which has been modified from its original condition

### - IMPORTANT:

Not for domestic use! Use in open buildings please abide by the relevant national and local guidelines and regulations.

- Use only in well ventilated area. Not for use where exposed to weather

- The products are suitable for minimum heating space (General according to power 10W/cbm calculation). For example. 20KW minimum space capacity of 2000 cubic meters

### - WARNING:

Fire, burn, inhalation and explosion hazard. Keep solid combustibles, such as building materials, paper or cardboard, a safe distance away from the heater. Never use the heater in spaces which do or may contain volatile or airborne combustibles, or products such as gasoline, solvents, paint thinner, dust particles or unknown chemicals.

### - CAUTION

Due to the high surface and exhaust temperature, adults and children must observe clearances to avoid burns or clothing ignition . Do not touch, keep children, clothing, and combustibles away.

- Never point the heater directly at persons nearby. Install the heater such that it is not directly exposed to water spray rain and / or water

- operate only on a stable, level surface

- Do not use in a dusty atmosphere. Never restrict or duct inlet or outlet

- Use only with electrical power supply specified on rating plate, The electrical connection and earthing must comply with Europe standard

- Use only a properly earthed socket and or extension cord.

- Do not move, handle, or service while the heater is hot or in use

- Use only in accordance with national and local regulations, directives, and all other relevant restrictions.

### -CAUTION: Risk of electric shock. Do not open.

This appliance is supplied with European plug for your safety.

The value of the fuse fitted is marked on the pin face of the plug

Should the fuse need replacing, ensure the substitute is of the correct rating

### - WARNING:

The gas heaters must only be used on fire-resistant floors,. Safety distance: 2 meters from walls or other objects. The gas heater must not be used in rooms containing explosive powders, gas fumes, flammable substance and material. The burner must be regularly cleaned if used in dusty environments. All service operations must be carried out by duly authorised staff only.

# GETTING TO KNOW YOUR GAS HEATER

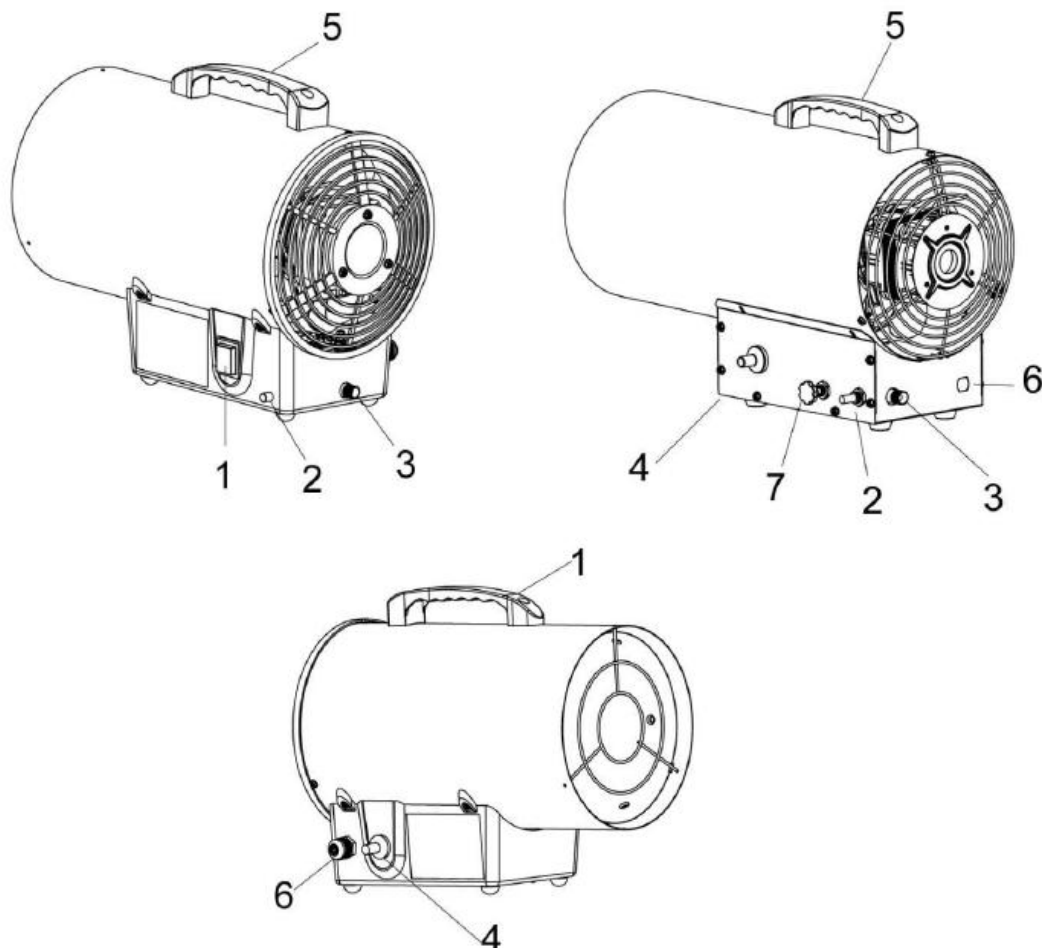

- ① On/off switch
- ② Safety start valve button
- ③ Gas inlet
- ④ Ignition button
- ⑤ Handle
- ⑥ Power cord

**UNPACKING:** After removing the packing material, make sure the product is in perfect condition and that there are no visible damaged parts. If in doubt, do not use the product and contact the dealer from whom it was purchased. Do not use until unit has been repaired.

The packing materials (plastic bags, polystyrene, etc ). Must be disposed of in an appropriate refuse collection container. These materials must not be left within the reach of children as they are potential sources of danger

# FUEL GASES

## - GUIDELINES OF FUEL GASES:

This heater is intended for the use of temporary heating of building under construction, alteration or repairing.

There may also be other local standards or regulations governing the use of fuel gases and heating products, of which you can get advice from your relevant local authority.

Propane and butane belong to the odorless fuel gases family. Normally gas suppliers will add an odor-making agent to help you detect a gas leakage. However the odor added can fade over time. Fuel gases maybe present even though no odor exists.

These heaters are intended for use with propane (I3p) or butane/ Propane mixes (I38\p), Any other fuel gas is unconsidered to use and dangerous.

To check the leakage of propane/butane, please use a professional gas leakage detector or simply with soap and water solution. **NEVER CHECK WITH A FLAME !**

Propane and butane are heavier than air. If there is a leakage, it sinks to the lowest possible level, collecting there with the surrounding air, forming a potentially explosive mixture, **It is prohibited to use these gas heaters in high rise flats, bedrooms, bathrooms, basements or below ground level.**

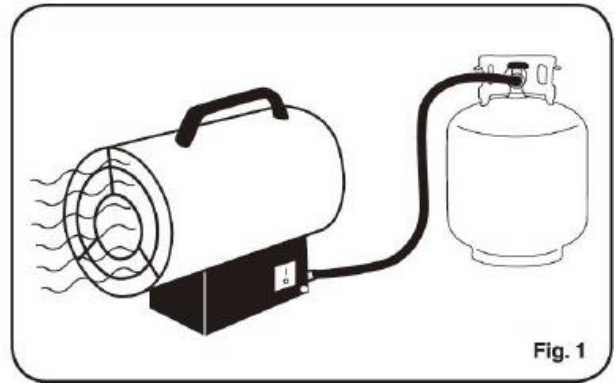

# VENTILATION

## - WARNING:

Be sure that the heater is only ever used with correct ventilation. Make sure that no object may obstruct the fan air intake (Fig.2)

## - OXYGEN DELETION:

The combustion of propane will consume a lot of oxygen (of butane even more). The minimum ventilation required by these heaters is  $30\text{cm}^3$  per KW heater output is strongly recommended. Never use the heater in an enclosed space

## - CARBON MONOXIDE (CO) POISONING

Even though the direct-fired system of this heater operates very closed to 100% combustion efficiency, it still generates small amounts of CO. Some people are more affected by CO than others, The symptoms of CO sensitivity are headache, dizziness, burning eyes and nose, nausea, dry mouth or sore throat, etc. Be sure to follow advice about ventilation.

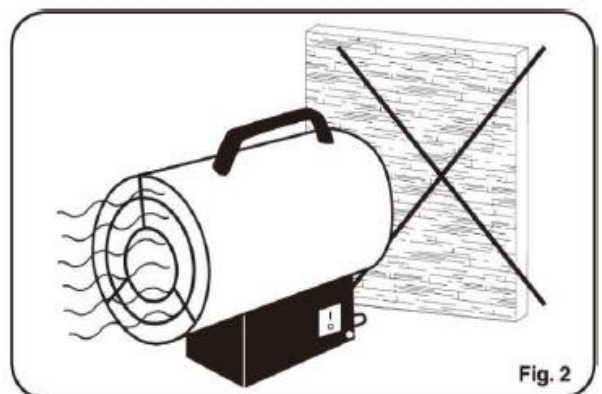

# OPERATION AND USE

## - PROPARING FOR OPERATION (Fig.3):

- Check the heater thoroughly for damage. Do not use a damaged heater. Be sure the heating area is adequately ventilated, free of moisture and dust, far away from any combustibile material. Always put the gas cylinder behind the heater in a stable position. Never put the gas cylinder in front of the heater (Fig.3.).

## - IMPORTANT:

Locate heater at a safe distance from any combustibile materials. (Fig.4.).

- Check the outlet pressure of the gas regulator and gas hose according to the specification on the rating plate. Use only local standard approved gas regulator and approved gas hose. Gas hose should be in its natural form without excessive bending and not twisted or kinked, ensure all connections are gas tight.

## - WARNING

When connecting to the gas cylinder, ensure the area is flame free to prevent risk of explosion.

- Screw fasten the gas hose with regulator to the cylinder valve. Ensure the connection is tight.

## - NOTE

The gas connection to the heater has a left hand thread

## - WARNING:

Do not adjust regulator

- Screw fasten the gas hose to the heater ensuring that the rubber hose is not twisted or kinked. Ensure the connection is gas tight.

## - START (Fig.5.):

- Plug in the mains lead to a wall socket.

- Press the ON/OFF switch (A) on, Let the motor fan run at least 30 seconds to check if the fan works properly and/or to purge any fuel gas left from the last use

- When the rubber hose attached to the gas inlet (B) . Open the gas valve on the cylinder slowly. Be sure there is no gas leakage.

- Push in and hold the safety start valve button (C) . Push ignition button (D) repeatedly until the burner lights.

**If the heater does not light within 30 seconds, wait a minimum of 3 minutes before retrying the correct ignition circuit**

- After the burner lights, keep the safety start valve button depressed for at least 30 seconds then slowly release and the heater will continue to operate.

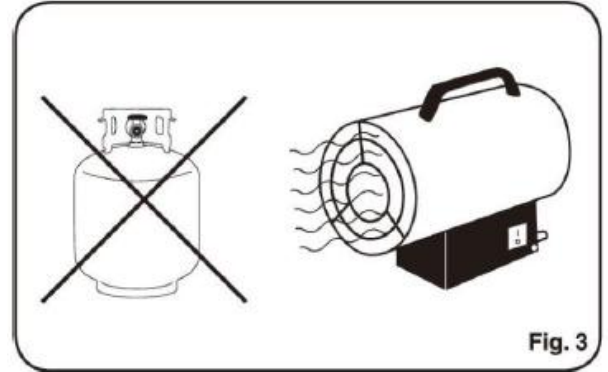

Fig. 3

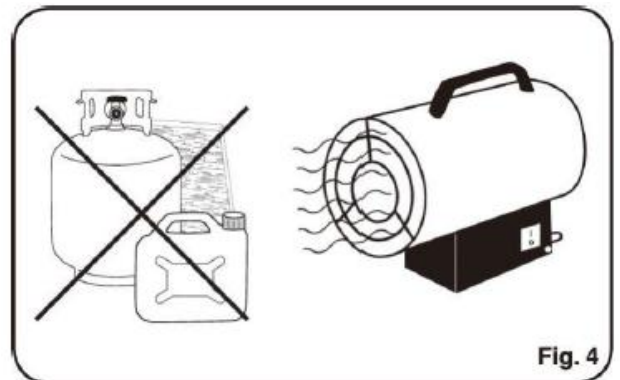

Fig. 4

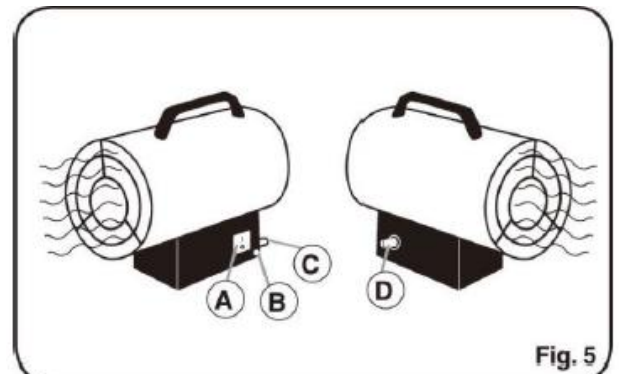
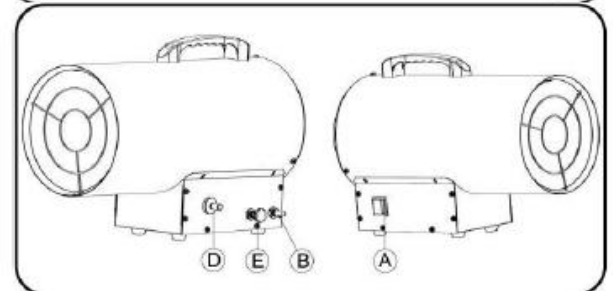

Fig. 5





## OPERATION AND USE

- STOP (Fig.6.):
- To switch off the heater, always closed the gas cylinder valve first.
- Let the motor fan run for at least 2 minutes until the heater has cooled down.
- Switch off the motor unplug the power cord.
- If the heater will not be used again shortly. Disconnect the gas hose from the heater first, then disconnect the hose and regulator from the valve on the gas cylinder.

- WARNING:

Be sure that the valve on the gas cylinder has been shut off firmly before disconnection. When changing the cylinder be sure the atmosphere is flame free. Should there be any gas leakage during operation, close the gas cylinder immediately, open all windows and doors, do not operate any equipment that may cause a spark (Light switches etc.) and inform the fire brigade as necessary

-IMPORTANT: The in-use period between every repeat operation should not be less than 3 minutes.

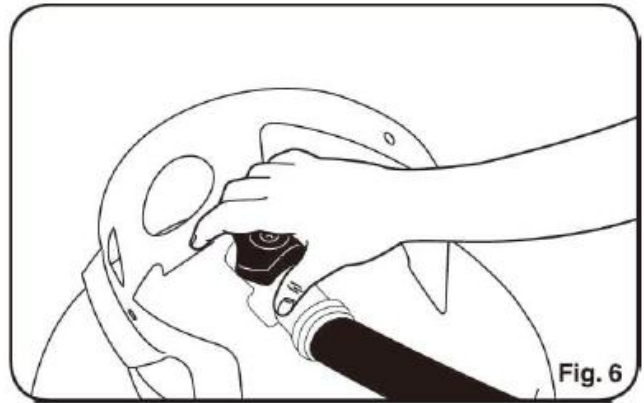

## MAINTENANCE AND STORAGE

Regular inspection and cleaning reduces the necessity for maintenance operations and will keep your heaters in good working condition.

The Motor must be correctly ventilated during the heater is operating. For this reason avoid blocking the air inlets.

If the replacement of the supply cord is necessary, this has to be done by the manufacturer or his agent in order to avoid a safety hazard.

Remove the plug from the socket before carrying out any adjustment, servicing or maintenance.

- Keep the heater clean, especially the motor grid and fan blades.
- Store the heater in a dry, clean and safe place away from the reach of children.
- The heater should be inspected at least one a year by a qualified person.
- Check the gas hose and its screw connections frequently
- Repair can only be made by a suitably trained and qualified person



# TROUBLESHOOTING

PROBLEM	CAUSE	REMEDY
Fan doesn't work	<ol style="list-style-type: none"> <li>1.No electricity</li> <li>2.Blade stalled by hosing</li> </ol>	<ol style="list-style-type: none"> <li>1.Check power supply</li> <li>2.Repair/replace housing</li> </ol>
Piezo will not ignite	<ol style="list-style-type: none"> <li>1.Ignition cable damage</li> <li>2.Ignition cable disconnected</li> <li>3.Distance between electrode and burner is too high</li> </ol>	<ol style="list-style-type: none"> <li>1.Only by a qualified person</li> <li>2.Only by a qualified person</li> <li>3.Adjust distance within 3-8 mm</li> </ol>
No gas	<ol style="list-style-type: none"> <li>1.Gas cylinder is empty</li> <li>2.Gas valve on cylinder closed</li> <li>3.Gas valve of heater not open</li> </ol>	<ol style="list-style-type: none"> <li>1.Replace new gas cylinder</li> <li>2.Open the valve</li> <li>3.Attempt re-light sequence correctly</li> </ol>
Flame goes out while heater running	<ol style="list-style-type: none"> <li>1.Thermo-element was not heated enough</li> <li>2.Safety thermostat activated</li> <li>3.Restricted air flow</li> </ol>	<ol style="list-style-type: none"> <li>1.Repeat ignition process and keep safety gas valve depressed for a minimum of 30 seconds, then release slowly</li> <li>2.Allow the heater to cool down for at least 10 minutes. Check thermostat and then attempt re-light sequence correctly</li> <li>3.Check heater inlet and outlet, remove any obstructions</li> </ol>

# DISPOSAL

- At the end of the machines' working life, or when it can no longer be repaired, ensure that it is disposed of according to national regulations
  - Contact your local authority for details of collection Schemes in your area.
- In all circumstance:
- Do not dispose of power tools with domestic waste.
  - Do not incinerate.
  - Do not abandon in the environment.
  - Do not dispose of WEEE\*
- As unsorted municipal waste.



- Waste Electrical & Electronic Equipment.

**FEIDER**  
MACHINES

Déclaration **CE** de conformité

**BUILDER SAS**  
ZI, 32 RUE ARISTIDE BERGES – 312070 CUGNAUX – FRANCE

Declare that the machine designated below:

**Gas heater 15KW**  
**Model: FCD15KW-1**

**S/N: 20200821150-20200821299**

Complies with the provisions of the following European directives:

**Directive (EU)2016/426**  
**LVD Directive 2014/35 / EU**  
**EMC Directive 2014/30 / EU**  
**ROHS Directive 2011/65 / EU+2015/863**

Also conforms to the following standards

**EN 1596:1998+ A1:2004**  
**EN 55014 - 1: 2017**  
**EN 55014 - 2: 2015**  
**EN 61000 - 3 - 2: 2014**  
**EN 61000 - 3 - 3: 2013**  
**EN 60335-2-102: 2016**  
**EN 60335-1: 2012+A11: 2014+A12: 2017**  
**EN 62233:2008**

Cugnaux, 27/06/2020



Philippe MARIE / PDG



Responsible for the technical file: Mr Olivier Patriarca

# WARRANTY



## WARRANTY

The manufacturer guarantees the product against defects in material and workmanship for a period of 2 years from the date of the original purchase. The warranty only applies if the product is for household use. The warranty does not cover breakdowns due to normal wear and tear.

The manufacturer agrees to replace parts identified as defective by the designated distributor. The manufacturer does not accept responsibility for the replacement of the machine, in whole or in part, and/or ensuing damage.

### The warranty does not cover breakdowns due to:

- insufficient maintenance.
- abnormal assembly, adjustment or operations of the product.
- parts subject to normal wear and tear.

### The warranty does not extend to:

- shipping and packaging costs.
- using the tool for a purpose other than that for which it was designed.
- the use and maintenance of the machine done in a manner not described in the user manual.

Due to our policy of continuous product improvement, we reserve the right to alter or change specifications without notice. Consequently, the product may be different from the information contained therein, but a modification will be undertaken without notice if it is recognized as an improvement of the preceding characteristic.

### READ THE MANUAL CAREFULLY BEFORE USING THE MACHINE.

When ordering spare parts, please indicate the part number or code, you can find this in the spare parts list in this manual. Keep the purchase receipt; without it, the warranty is invalid. To help you with your product, we invite you to contact us by phone or via our website:

- **+33 (0)9.70.75.30.30**
- **<https://services.swap-europe.com/contact>**

You must create a "ticket" via the web platform.

- Register or create your account.
- Indicate the reference of the tool.
- Choose the subject of your request.
- Describe your problem.
- Attach these files: invoice or sales receipt, photo of the identification plate (serial number), photo of the part you need (for example: pins on the transformer plug which are broken).



# PRODUCT FAILURE

## WHAT TO DO IF MY MACHINE BREAKS DOWN?

### If you bought your product in a store:

- a) Empty the fuel tank.
- b) Make sure that your machine is complete with all accessories supplied, and clean! If this is not the case, the repairer will refuse the machine.

Go to the store with the complete machine and with the receipt or invoice.

### If you bought your product on a website:

- a) Empty the fuel tank.
- b) Make sure that your machine is complete with all accessories supplied, and clean! If this is not the case, the repairer will refuse the machine.
- c) Create a SWAP-Europe service ticket on the site: <https://services.swap-europe.com> When making the request on SWAP-Europe, you must attach the invoice and the photo of the nameplate (serial number).
- d) Contact the repair station to make sure it is available before dropping off the machine.

Go to the repair station with the complete machine packed, accompanied by the purchase invoice and the station support sheet downloadable after the service request is completed on the SWAP-Europe site

For machines with engine failure from manufacturers BRIGGS & STRATTON, HONDA and RATO, please refer to the following instructions.

Repairs will be done by approved engine manufacturers of these manufacturers, see their site:

- <http://www.briggsandstratton.com/eu/fr>
- <http://www.honda-engines-eu.com/fr/service-network-page;jsessionid=5EE8456CF39CD572AA2AEEDFD290CDAE>
- <https://www.rato-europe.com/it/service-network>

**Please keep your original packaging to allow for after-sales service returns or pack your machine with a similar cardboard box of the same dimensions.**

**For any question concerning our after-sales service you can make a request on our website <https://services.swap-europe.com>**

**Our hotline remains available at +33 (9) 70 75 30 30.**



# WARRANTY EXCLUSIONS

## THE WARRANTY DOES NOT COVER:

- Start-up and setting up of the product.
- Damage resulting from normal wear and tear of the product.
- Damage resulting from improper use of the product.
- Damage resulting from assembly or start-up not in accordance with the user manual.
- Breakdowns related to carburetion beyond 90 days and fouling of carburetors.
- Periodic and standard maintenance events.
- Actions of modification and dismantling that directly void the warranty.
- Products whose original authentication marking (brand, serial number) has been degraded, altered or withdrawn.
- Replacement of consumables.
- The use of non-original parts.
- Breakage of parts following impacts or projections.
- Accessories breakdowns.
- Defects and their consequences linked to any external cause.
- Loss of components and loss due to insufficient screwing.
- Cutting components and any damage related to the loosening of parts.
- Overload or overheating.
- Poor power supply quality: faulty voltage, voltage error, etc.
- Damages resulting from the deprivation of enjoyment of the product during the time necessary for repairs and more generally the costs related to the immobilization of the product.
- The costs of a second opinion established by a third party following an estimate by a SWAP-Europe repair station
- The use of a product which would show a defect or a breakage which was not the subject of an immediate report and/or repair with the services of SWAP-Europe.
- Deterioration linked to transport and storage\*.
- Launchers beyond 90 days.
- Oil, petrol, grease.
- Damages related to the use of non-compliant fuels or lubricants.

\* In accordance with transport legislation, damage related to transport must be declared to carriers within 48 hours maximum after observation by registered letter with acknowledgement of receipt.

This document is a supplement to your notice, a non-exhaustive list.

**Attention:** all orders must be checked in the presence of the delivery person. In case of refusal by the delivery person, it you must simply refuse the delivery and notify your refusal.

**Reminder:** the reserves do not exclude the notification by registered letter with acknowledgement within 72 hours.

### Information:

Thermal devices must be wintered each season (service available on the SWAP-Europe site). Batteries must be charged before being stored.